

INSTRUCTION MANUAL

57KG (125LB) PUSH SPREADER

MODEL NO: SPR571

EN - ORIGINAL INSTRUCTIONS

ASSEMBLY REQUIRED
SAVE THESE INSTRUCTIONS
SPARES & SUPPORT

FOR YOUR SAFETY

Please read & understand this manual, paying attention to the safety instructions, before use.

Incorrect use of the product could put the operator or machine in danger.

Whilst every effort has been made to ensure the accuracy of information contained in this manual, our policy of continuous improvement determines the right to make modifications without prior warning.

Images used are for illustration purposes only

CONTENTS

SPECIFICATION

IMPORTANT INFORMATION

GENERAL SAFETY INSTRUCTIONS

COMPONENTS

ASSEMBLY

OPERATION

MAINTENANCE

PARTS DIAGRAM

PARTS LIST

ASSEMBLY IS REQUIRED - MINIMUM TWO PERSONS

- This product requires assembly before use.
- See “Assembly” section for instructions.
- Because of the weight and/or size of the machine, it is recommended that another adult is present to assist with the assembly.
- Inspect all components closely upon receipt to make sure no items are missing or damaged.



WARNING

Read this instruction manual carefully before operating this machine. Make sure that you are familiar with the controls and properly operate the machine. Following these instructions can reduce the risk of personal injury.

SPECIFICATIONS

The manufacturer reserves the right to change the product specification and livery according to continued product improvements.

Model	SPR571
Capacity (Weight)	57kg (125lb)
Hopper Dimensions (cm)	71X46X34
Overall Dimensions (cm)	92X78X102
Product Weight (kgs)	18
Tyre Rating	2 Ply
Tyre Maximum PSI	20psi (Do not exceed)

IMPORTANT INFORMATION

INTENDED USAGE



WARNING

Persons should never ride on the spreader.

Read this instruction manual carefully before operating this machine. Make sure that you are familiar with the controls and properly operate the machine. Following these instructions can reduce the risk of personal injury.

The spreader is designed for use in private gardens and primarily for spreading granular material in and around domestic gardens. Ideal for fertiliser, granules, grass seed etc. This product can be used with refined ice melting salt, but please clean the spreader thoroughly after use with refined de-icing salt.

Extended use over abrasive surfaces (e.g. concrete, tarmac, paving etc.) could cause premature wear on the spreader tyres. Commercial or industrial environments are not recommended.

Generally acknowledged accident prevention regulations and enclosed safety instructions must be observed. Only perform work described in these instructions for use, any other use is incorrect. The manufacturer will not assume responsibility for damage resulting from such use.

IF NOT USED PROPERLY THIS MACHINE CAN BE DANGEROUS!

This machine can cause serious injury to the operator and others, the warning and safety instructions must be followed to ensure reasonable safety and efficiency in using this product. The operator is responsible for following the warning and safety instructions in this manual and on the machine. Never use the product unless the components are correctly positioned and operational.

TRAINING









Read the instructions carefully: Be familiar with the controls and the proper use of the equipment.

Never allow children or people unfamiliar with these instructions to use the product.

Local regulations can restrict the age of the operator. Keep in mind that the operator or user is responsible for accidents or hazards involving the machine that occur to other people or their property.

GENERAL SAFETY INSTRUCTIONS

It is important that you read and understand the owner's manual and labels affixed to the machine. Learn its application and limitations as well as the specific potential hazards. Retain these instructions for future reference. The operator is responsible for following the warnings & instructions in this manual and on the product.

	Read & understand the operator's manual for the spreader. Failure to follow instructions could result in death or serious injury.		Risk of Slicing. Keep hands out of the way of all moving parts.
	Wear gloves to protect your hands. Wear recognised eye protection at all times.		Check your machine before using. Keep guards in place and in working order. Frequently check to see that foreign objects are removed before using. Replace damaged, missing or failed parts before using it.
SLOPES	Be careful when using on slopes. Do not operate on inclines greater than 15°. It is advised to work across the incline, not up and down.		Safety alert symbol. Used to alert you to potential personal injury hazards. Obey all safety messages that follow this symbol to avoid possible injury.
 DANGER	Indicates an imminently hazardous situation which, if not avoided, will result in serious injury.	 WARNING	Indicates a potentially hazardous situation which, if not avoided, could result in serious injury.
 CAUTION	Indicates a potentially hazardous situation which, if not avoided, may result in minor or moderate injury.	CAUTION	Used without the safety alert symbol indicates a potentially hazardous situation which, if not avoided, may result in property damage.

IMPORTANT SAFETY WARNINGS



TO REDUCE RISK OF INJURY: Before any use be sure everyone using this product reads and understands all safety instructions and other information contained in this manual.



WARNING

The warnings, cautions, and instructions outlined in this instruction manual cannot cover all possible conditions or situations that may occur. It must be understood by the operator that common sense and caution are factors which cannot be built into this product and must be supplied by the operator.

GENERAL SAFETY

STAY ALERT

Do not operate the machine while under the influence of drugs, alcohol, or any medication that could affect your ability to use it properly. Do not use this machine when you are tired or distracted from the job at hand. Be aware of what you are doing at all times. Use common sense.

SMALL COMPONENTS

Contains small components that could be a choking hazard if swallowed. Keep these items away from children.

USERS, BYSTANDERS AND CHILDREN

Do not at any time carry passengers in or on the spreader, stationary or whilst moving. Do not allow any person, child or pet to play on, stand, sit, lay or climb in or on the spreader. Never allow children or people unfamiliar with these instructions to use the spreader. Local regulations can restrict the age of the operator. Keep unauthorised persons a safe distance away from the machine. If approached, stop the machine immediately.

AVOID DANGEROUS CONDITIONS

Work in daylight or in good artificial light; walk, never run with the machine; always be sure of your footing on slopes; exercise extreme caution when changing direction on slopes; do not work on excessively steep slopes; use extreme caution when reversing or pulling the machine towards you; do not put hands or feet near or under rotating or moving parts. When operating on slopes, across the incline.

INSPECT YOUR MACHINE

Check all bolts, nuts, and screws for tightness before each use, especially those securing guards and drive mechanisms. Vibration during use, may cause these to loosen.

Form a habit of checking to see that all other tools/equipment are removed from the working area before operating. Replace damaged, missing or failed parts before using. Warning labels carry important information. Replace any missing or damaged warning labels.

DRESS PROPERLY

Be careful of loose clothing and other accessories (watches, necklaces etc.) which can be caught in moving parts. Long trousers are advisable. Always wear substantial non-slip footwear when operating. Never operate barefoot or when wearing sandals. Wear a face or dust mask if the operation is dusty. Wear protective hair covering to contain long hair, preventing it from getting caught in machinery.

DO NOT OVERREACH

Always keep proper footing and balance when operating. Use on slopes with great care. Never stand on the machine. Serious injury could occur if the machine is tipped or if the moving parts are unintentionally contacted. Do not store anything above or near the machine, where anyone might stand on the machine to reach them.

DO NOT FORCE TOOL

Do not exceed maximum load capacity of 57kg (125lb). Avoid large holes and ditches when transporting loads. Always work within the rated capacity. Do not use for a purpose for which it was not intended. Be careful when operating on steep slopes, the spreader may tip over. Always operate at reduce speed in rough terrain, along creeks, ditches and on hillsides. To avoid personal injury and/or equipment damage **DO NOT EXCEED 10 MPH**. Always use caution when loading and unloading the hopper.

INSPECT

Before using, always visually inspect to see that the machine is not worn or damaged. Replace worn or damaged elements and bolts in sets, to preserve balance.

MAINTAIN YOUR MACHINE WITH CARE

Clean the machine immediately after use. Keep the machine clean to ensure it operates to its full and safest performance. When maintaining this machine, only the manufacturer's original replacement parts should be used. The use of non-original manufacturer parts may invalidate your warranty.

PROTECT THE ENVIRONMENT

Take left over materials to an authorised collection point or follow the stipulations in the country where the machine is used. Do not discharge into drains, soil or water.

STORE IDLE EQUIPMENT

When not in use, store in a dry location. Keep the machine away from children and others not qualified to use it. Keep away from direct sunlight.

TYRE INFLATION

Before operating, make sure the tyres have the recommended pressure of 20 PSI (**Do not exceed 20 PSI**). We recommend the use of **FOOT or HAND** inflation devices only. This is a garden/domestic spreader, therefore extended use over abrasive surfaces (e.g. concrete, tarmac etc.) could cause premature wear on the tyres.

KNOW YOUR MACHINE

Read this owner's manual before operating the equipment. Familiarize yourself with the location and function of the controls and features. Save this manual for future reference.

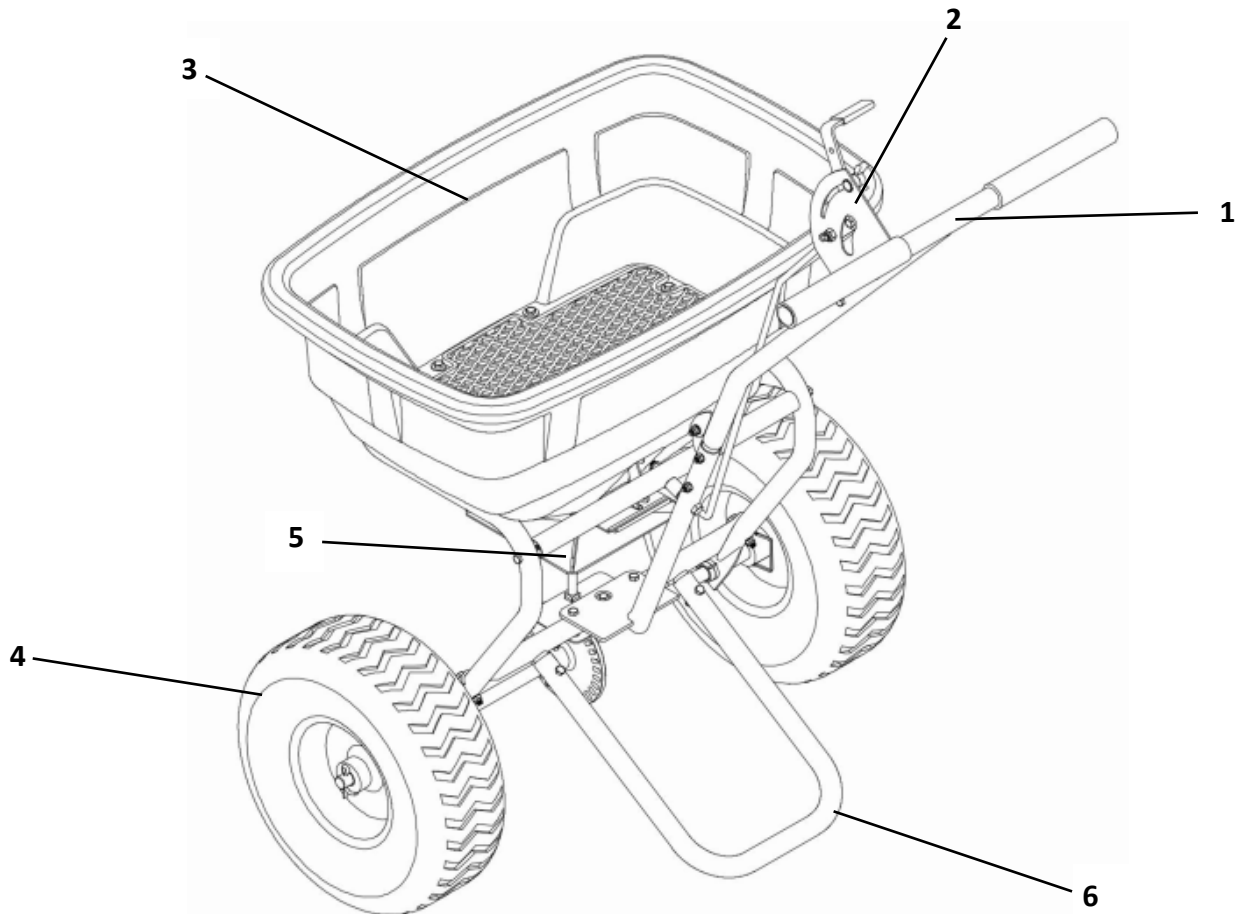

1. **T-Handle** – Pushes and moves the spreader easily.
2. **Flow Control** – Controls the flow of material being spread
3. **Hopper** – Do not exceed rated load capacity 125lb (57kgs).
4. **Tyre/Wheel** – Do not exceed recommended inflation rated 20 PSI.
5. **Impeller** - Evenly distributes material.
6. **Support Leg** – Stabilizes load and spreader, when stationary.

COMPONENTS

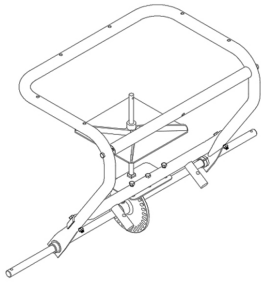

Frame Tube Assembly
1PC

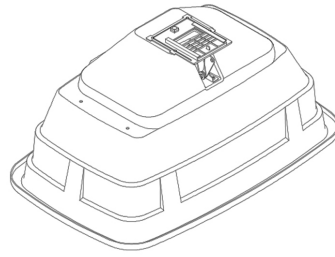

Hopper
1PC

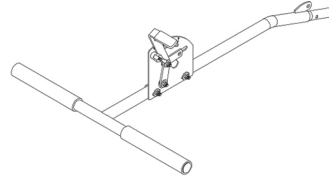

Handle Preassembly
1PC

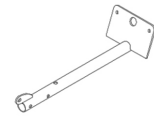

Support Tube
1PC



Support Tube
1PC

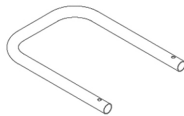

Support Leg
1PC

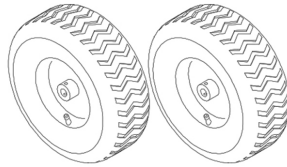

Wheel
2PCS



Screen
1PC

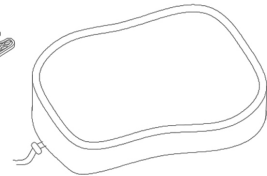

Rain Cover
1PC



Hex Bolt M8X75
1PC



Hex Bolt M6X40
6PCS



Hex Bolt M6X35
4PCS



Hex Bolt M6X20
1PC



R Pin
1PC



Lock
Nut M8
3PCS



Lock
Nut M6
11PCS



Flat
Washer Ø16
6PCS



Flat
Washer Ø8
2PCS



Big Flat
Washer Ø6
6PCS



Flat
Washer Ø6
2PCS



Spring
Washer Ø6
3PCS

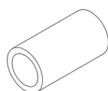

Bushing
2PCS

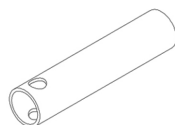

Bushing
2PCS



Drive Pin
1PC



Spacer
1PC



Cotter Pin Ø5X35
2PCS

STEP 1 - Wheels

1. Put the two sides of the U-shaped stay feet on the connecting shaft of the frame tube assembly, align the upper holes, and secure them with two hex bolts M6x35 and two lock nuts M6.
2. Install the tire spacer, tire bushing and tire on the axle in turn, and assemble it with a flat washer Ø16 and a cotter pin Ø5×35 outside. Once the hole on the right inside of the tire is aligned with the hole on the tire bushing, secure it with a drive pin.

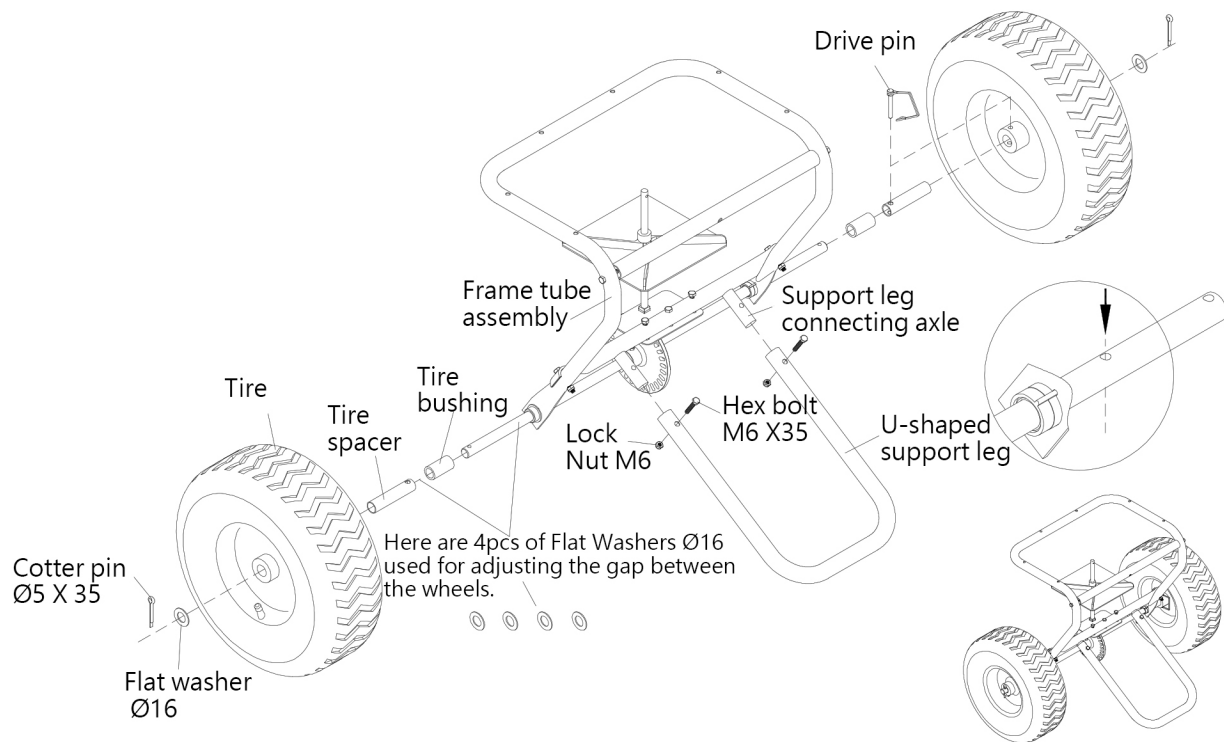

Figure1

Step 2

As shown in Figure 2, install the mounting plate of the support tube to the transverse tube using 2 hex bolts M6x40, 2 large washers Ø6 and 2 lock nuts M6.

Connect the upper part of the support tube to the tube above the frame tube assembly with one hex bolt M8x75, one spacer and one lock nut M8.

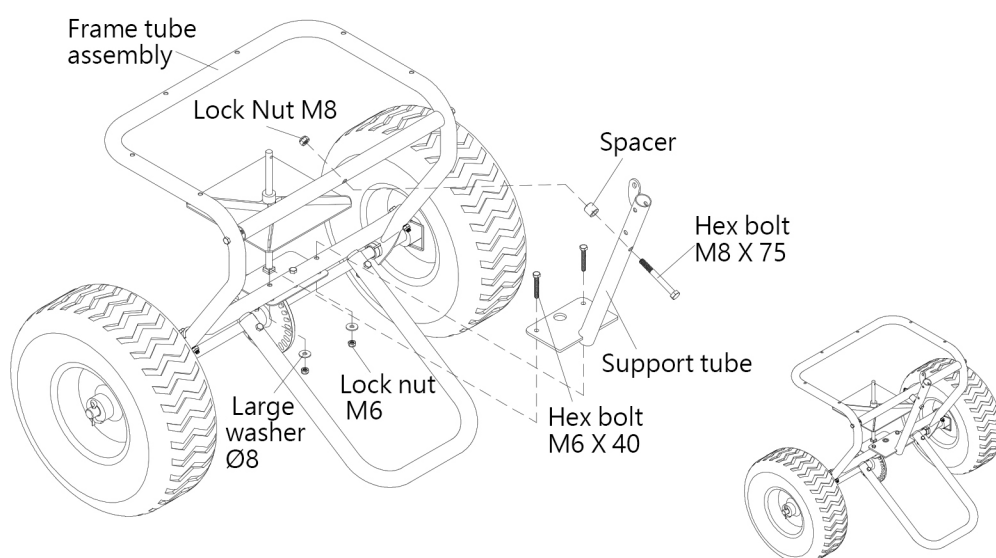

Figure 2

Step 3 - Hopper

As shown in Figure 3, the rotating shaft of the frame tube assembly passes through the central hole of the hopper, and the hopper components are installed on the frame tube assembly with 6 hex bolts M6x40, 6 large washers Ø6 and 6 lock nuts M6, and Insert R pin Ø3 in the small hole of the rotating shaft.

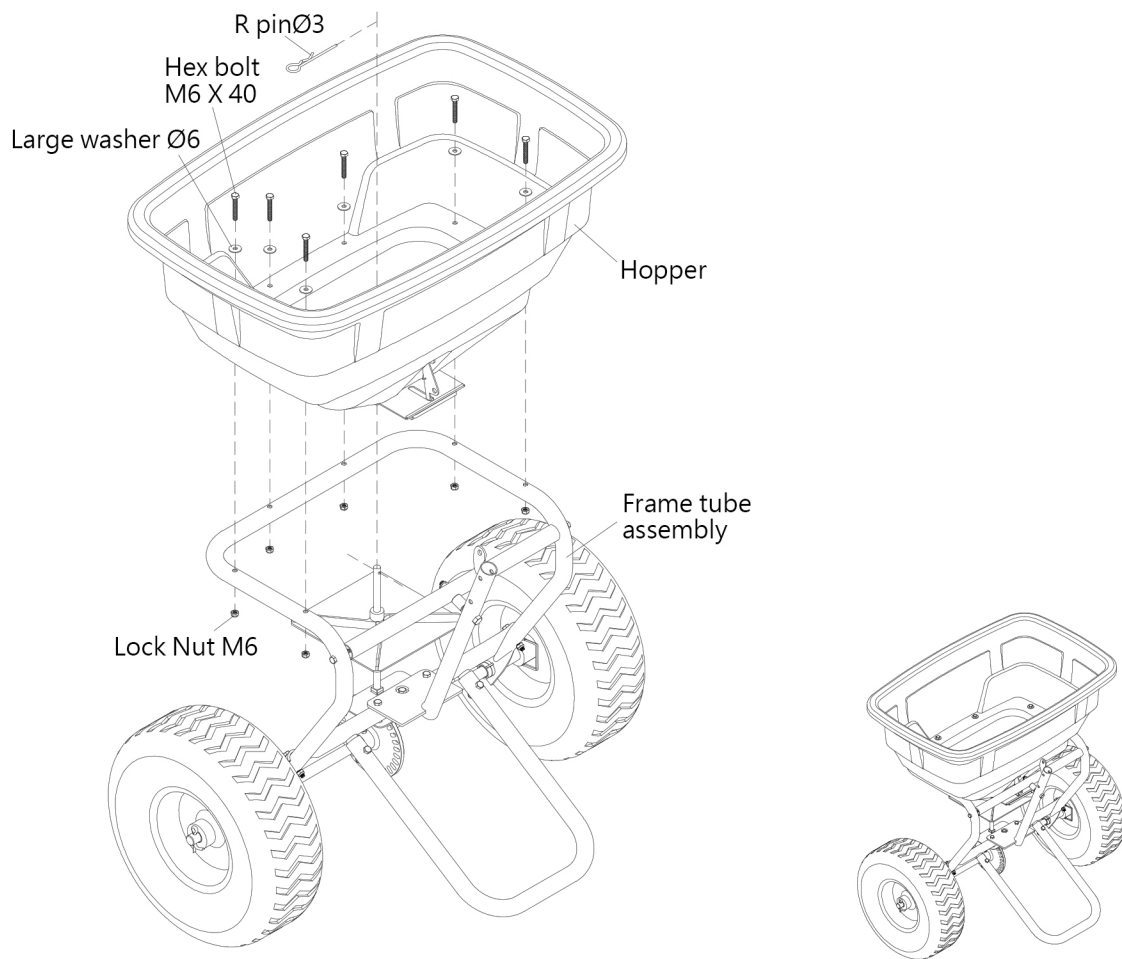

Figure 3

Step4 - Connecting handle

As shown in Figure 4, insert the lower end of the handle component into the support tube of the frame tube assembly, connect the pipe with two hex bolts M6x35, two spring washers Ø6 and two lock nuts M6, and secure the handle connection plate with one hex bolt M6x20, two flat washers Ø6, one spring washer Ø6 and one lock nut M6.

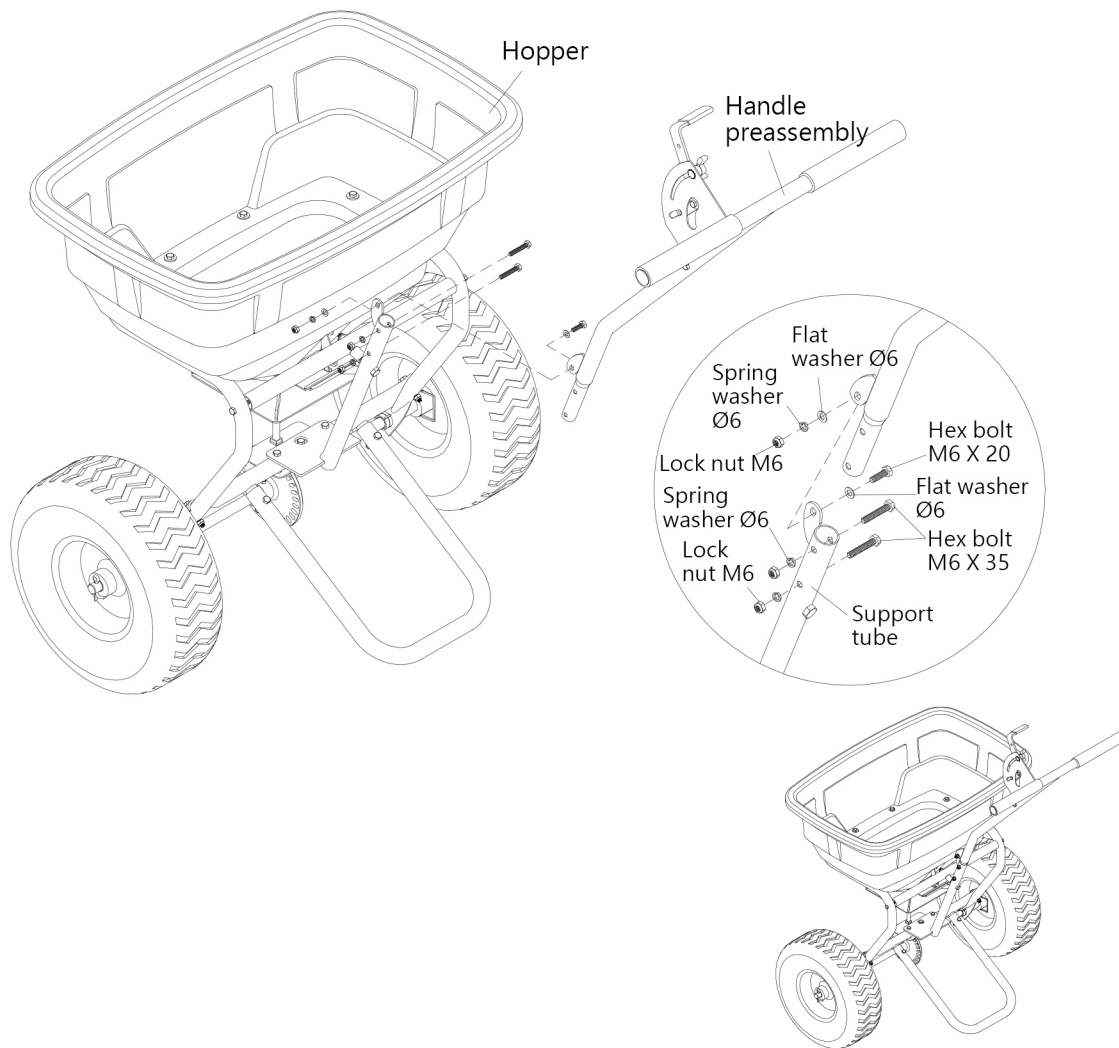

Figure 4

Step 5 - Solid Linkage

As shown in Figure 5, use a flat washer $\varnothing 8$ and a nylon lock nut M8 to connect the upper end of the adjusting rod to the connecting rod connecting plate mounting hole of the adjusting handle component, and then use another flat washer $\varnothing 8$ and a nylon lock nut M8 to connect the lower end of the adjusting rod to the connecting rod fixing plate mounting hole at the bottom of the hopper.

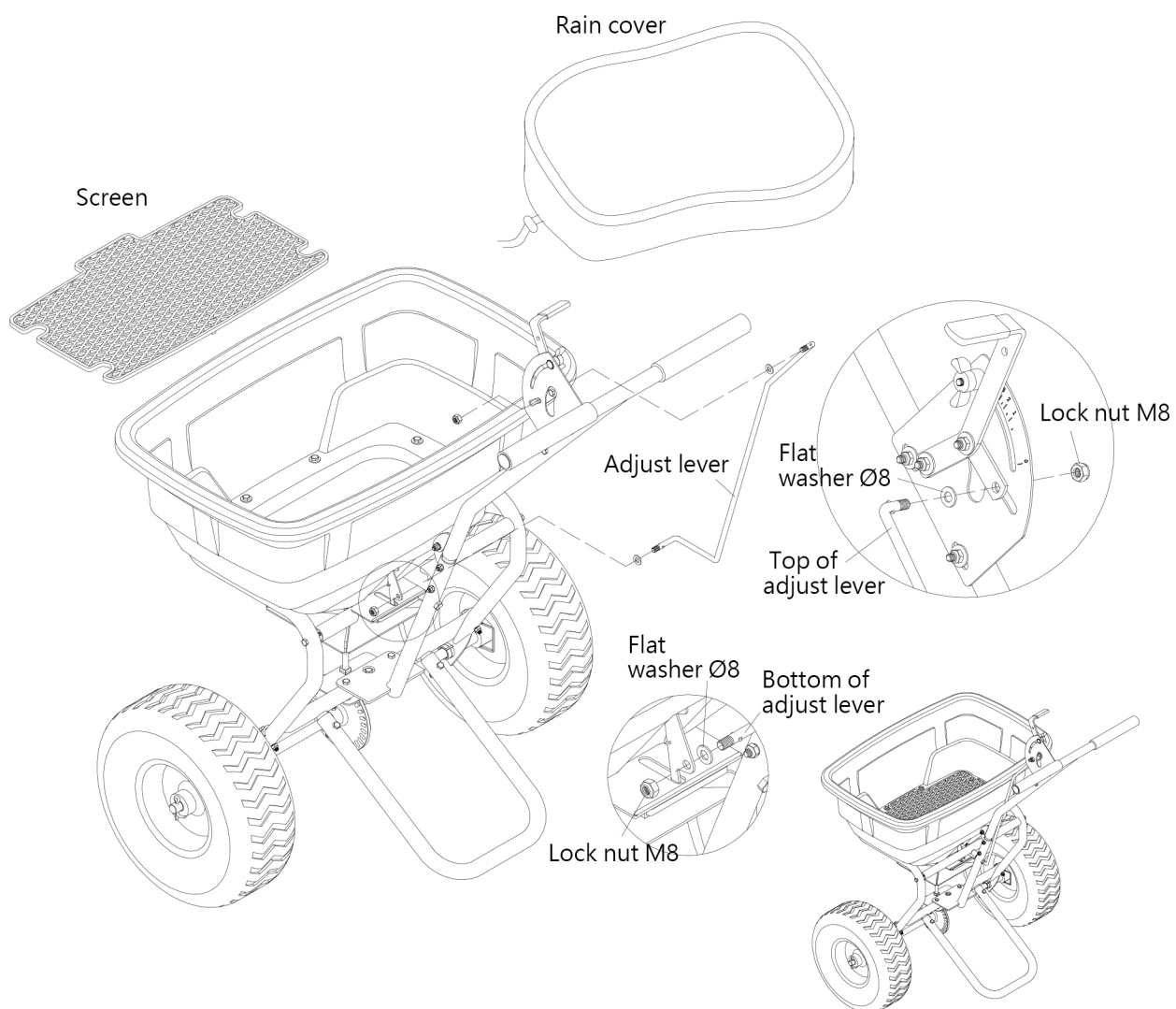

Figure 5

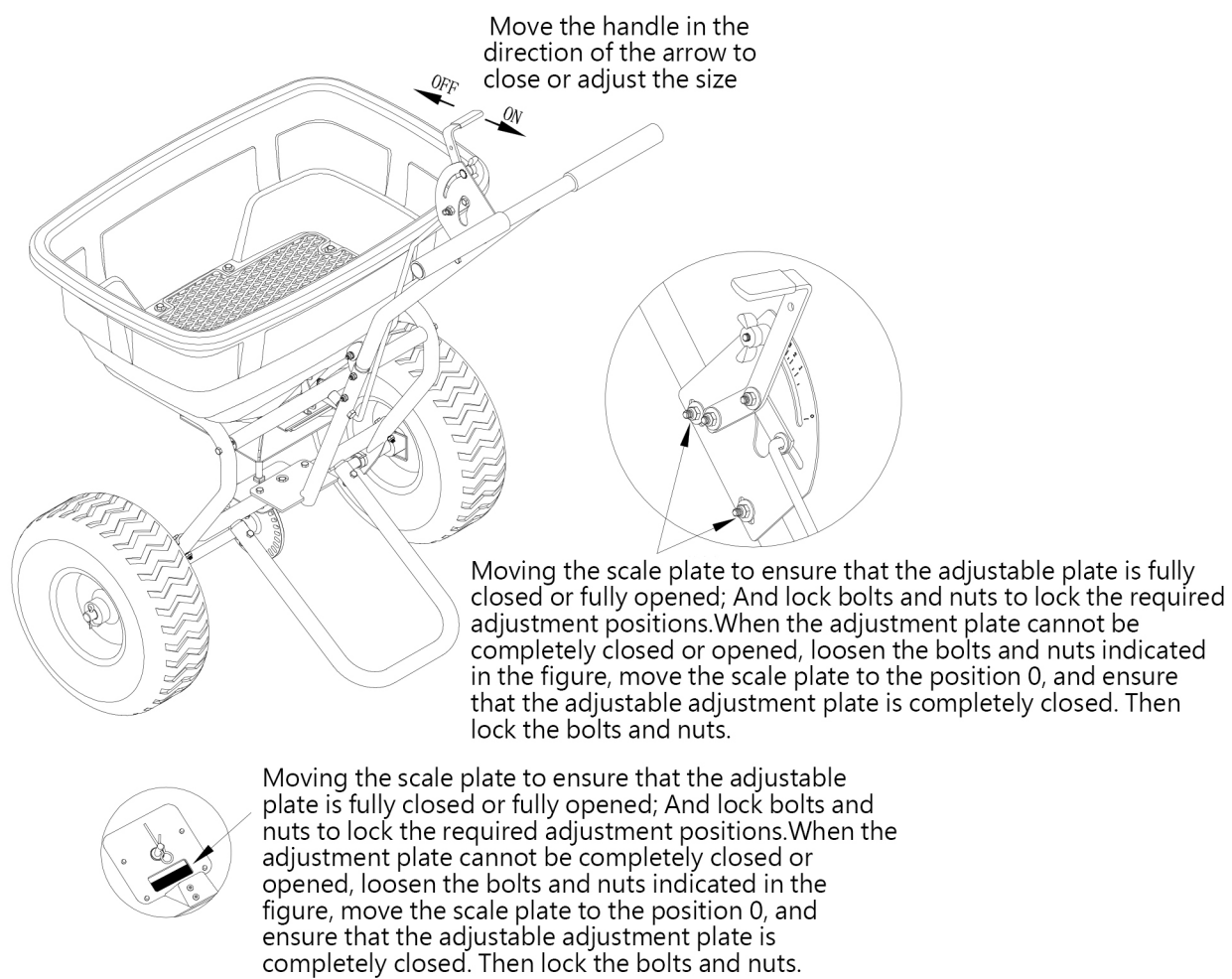

Figure 6

OPERATION



DANGER

The product must only be put into operation if no defects are found. It is crucial that any defective parts are replaced before the product is used again. Check the safety equipment and the safe condition of the product: Check all parts to make sure that they fit tightly. Check whether there are any visible defects: broken parts, cracks, etc.



DANGER

DO NOT EXCEED THE EQUIPMENT MAXIMUM LOAD CAPACITY OF 57kg (125lb).

Before filling the hopper, familiarise yourself with the operation of this Spreader.

- The Spreader is designed to be pushed at 3 miles per hour – brisk walking pace. The rate of walking will affect the spread pattern and flow rate.
- Move the Wing Nut attached to the stop bolt on the gauge to the relevant setting.
- Start pushing the Spreader forward & pull the control lever back to the stop bolt, opening the feed-gate hole at the bottom of the hopper.
- If the Spreader does not spread evenly, ensure that the FRONT of the gearbox points towards the front of the Spreader. The impellor must rotate clockwise.
- Material which is stuck on the impellor blades will cause uneven spreading.
- To stop spreading, push the gauge lever forward to close the feed-gate hole in the hopper.
- Remove the agitator when using refined de-icing salt to reduce gearbox damage. Salt may corrode the machine and reduce its working life.
- If fertiliser is accidentally deposited too heavily in a small area, soak the area thoroughly with a garden hose or sprinkler to prevent burning the lawn.
- When broadcasting weed control fertilizers, make sure the broadcast pattern does not hit evergreen trees, flowers or shrubs.
- Always use the rain cover in wet weather conditions to keep the hopper contents dry.

RATE SETTINGS

Our spreaders are designed to spread dry, powdered or granulated materials thinly and evenly over reasonably smooth surfaces. Due to the many hundreds of different materials which can be used with this spreader, it is impossible to list them all and the relevant spreader setting for the material. We therefore recommend that you test the spread pattern on a hard surface (driveway etc), before passing over the area to be treated.

1. Inspect your spreader before each use. Make sure the wheels turn easily, and the impeller still moves when the spreader is pushed. The hopper should be clean and free from cracks.
2. Determine approximate square footage of the area to be covered and estimate amount of material required. Please refer to the spreader setting instructions later in the manual.
3. Spreader is useful for spreading a range of materials (Ice Melt, Fertilizer, Grass Seed). Materials such as Powder, Manure, Top Soil, Gravel, and Mulch have the wrong physical characteristics and should not be used with these spreaders.
4. Before filling the hopper, make sure that the flow control lever and the flow control plate are closed.
5. Make sure the R pin is installed through the gearbox spindle in the hopper before starting the spreader.
6. Break up any lumpy material as you fill the hopper.
7. Once you have determined your proper spreader setting and are using the spreader, keep the following thoughts in mind to optimize spreading results: Always set the adjustable stop with the flow control to the "0" position and continue moving one more stride whenever you are about to stop or turn the spreader. This action will close the flow control plate and stop the dispersing of material, which will result in reduced waste and avoid damaging the lawn with oversaturated material.
8. To maintain the same coverage when walking at a different speed, adjust the flow rate. Reduce the flow setting for slower speeds and increase the flow setting for higher speeds.
9. Keep the impeller plate horizontal when operating. Tilting the spreader will result in uneven coverage.

10. Always start walking prior to opening the flow control closure plate.
11. If spreading material is accidentally deposited too heavily in a small area, soak the area thoroughly with a garden hose or sprinkler to prevent burning of the lawn.
12. To ensure consistent coverage, make sure each scatter pattern slightly overlaps as shown in figure below. The approximate scatter widths for different materials are shown in the application chart.
13. When scattering spreading material, make sure material does not hit evergreen trees, flowers or shrubs.
14. Make sure you are appropriately dressed, including sturdy footwear. Protect yourself by wearing gloves and a dust mask when handling chemical lawn products that contain pesticides and herbicides.
15. Do not over apply spreading material. Follow the recommended coverage rate for each product. Over application will lead to lawn damage and contamination.



CAUTION

The rate settings are guidelines only. Even branded materials may vary in grain size, humidity, density etc. If in any doubt choose a lower setting than that suggested or start at a mid-setting and adjust as necessary, until an even spread is achieved.

Using rock salt in this spreader will damage the mechanism and shorten the life of the product. Refined ice melting salt can be used but the user should be aware that this is not a specialised salt spreader and using salt may corrode the spreader and reduce the life of the machine. Clean the spreader thoroughly after using refined de-icing salt.



WARNING

Do not over apply spreading material. Follow the recommended coverage rate for each product. Over application will lead to damage and contamination. If spreading material accidentally deposits too heavily, soak the area thoroughly with a garden hose or sprinkler to prevent burning.

CONSISTENT COVERAGE

To ensure consistent coverage, ensure each broadcast pattern slightly overlaps the previous, as shown below.

N.B. ALWAYS MOVE OFF BEFORE OPENING FEED-GATE. ALWAYS CLOSE FEED-GATE BEFORE STOPPING.

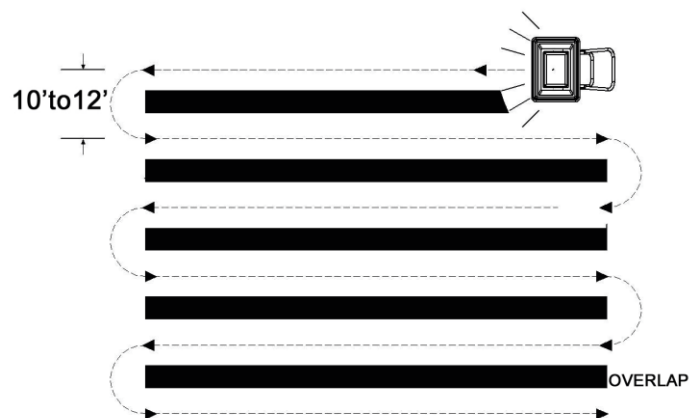

SPREADER SETTING INSTRUCTIONS

FOR MATERIALS THAT USE A TYPICAL 5,000 Sq. Ft, 10,000 Sq. Ft. & 15,000 Sq. Ft. COVERAGE VALUE

See additional spreader setting instructions on the following pages if your material coverage value is not typical.

To obtain the proper spreader setting for the material being spread, follow these steps:

1. Find the total weight in lbs. Of the product from the product label on the bag of material. Reference the nearest corresponding row in Chart A.
2. Find the coverage amount in square feet that the product is rated for from the product label on the bag of material. Reference the corresponding column in Chart A.
3. Find the nearest intersecting point of these two numbers from Chart A. (this number equals the lbs. per 1000 sq. ft.)
4. Use this number to find the nearest number in the column "lbs. / 1000 sq. ft." on Chart B to obtain the spreader setting.
5. You may have to approximate your spreader setting based upon the lbs. per 1000 sq. ft. number that you arrived at.

As an example:

1. *The fertilizer bag weighs 42 lbs.*
2. *The coverage value is rated at 15,000 square feet.*
3. *Use Chart A to find the corresponding column of coverage and nearest row of weight. The nearest intersecting point is approximately 2.8 since the bag weight is between 40 lbs. and 45 lbs.*
4. *Using Chart B, the number 2.8 is between 2 lbs. per 1000 sq. ft. and 3 lbs. per 1000 sq. ft.*
5. *Spreader setting would be 14.*

CHART A – SQUARE FOOT COVERAGE PER BAG*

(*) These are only estimates. Actual amounts may vary.

Weight Of Bag (LBS.)	LBS/1,000 SQ FT		
	5,000 SQ FT	10,000 SQ FT	15,000 SQ FT
5	1.0	0.5	0.3
10	2.0	1.0	0.7
15	3.0	1.5	1.0
20	4.0	2.0	1.3
25	5.0	2.5	1.7
30	6.0	3.0	2.0
35	7.0	3.5	2.3
40	8.0	4.0	2.7
45	9.0	4.5	3.0
50	10.0	5.0	3.3

CHART B – SPREADER SETTINGS/SPREAD WIDTHS*

(*) These are only estimates actual spreader setting and widths may vary depending on material.

LBS/1,000 SQ FT	SPREADER SETTING	SMALL PARTICLE SPREAD	MEDIUM PARTICLE SPREAD	LARGE PARTICLE SPREAD
1	10	5-6 ft.	6-9 ft.	9-12 ft.
2	12	5-6 ft.	6-9 ft.	9-12 ft.
3	14	5-6 ft.	6-9 ft.	9-12 ft.
4	15	5-6 ft.	6-9 ft.	9-12 ft.
5	17	5-6 ft.	6-9 ft.	9-12 ft.
6	18	5-6 ft.	6-9 ft.	9-12 ft.
7	20	5-6 ft.	6-9 ft.	9-12 ft.
8	21	5-6 ft.	6-9 ft.	9-12 ft.
9	23	5-6 ft.	6-9 ft.	9-12 ft.
10	25	5-6 ft.	6-9 ft.	9-12 ft.

ADDITIONAL INSTRUCTIONS

FOR MATERIALS THAT DO NOT USE A TYPICAL 5,000 Sq. Ft, 10,000 Sq. Ft. & 15,000 Sq. Ft. COVERAGE VALUE

To obtain the proper spreader setting for the material being spread, follow these steps:

1. Find the total weight in lbs. of the product from the product label on the bag of material.
2. Find the coverage amount in square feet that the product is rated for from the product label on the bag of material.
3. Divide the bag weight rated in lbs. by the square feet coverage rated on the bag.
4. Take this result and multiply it by 1000.
5. This final number is the lbs. of material to be spread per 1000 square feet.
6. Use this number in Chart B to obtain the proper spreader setting.

As an example:

1. The fertilizer bag weighs 10 lbs.
 2. The coverage value is rated at 2000 square feet.
 3. $10 \text{ lbs.} / 2000 \text{ square ft.} = 0.005$
 4. $0.005 \times 1000 = 5 \text{ lbs. per } 1000 \text{ sq. ft.}$
- Using this number in Chart B, you would obtain a spreader setting of 17.

MAINTENANCE

LUBRICATE

Maintenance spray or multi-purpose grease can be applied to the wheel axle prior to long-term storage. Oiling is not necessary.

GEARBOX

DO NOT open the gearbox. The gears are permanently lubricated from the factory and do not need lubricating.

CHECK TYRE INFLATION

Prior to using the spreader, ensure the tyres are sufficiently inflated. We recommend the use of FOOT or HAND inflation devices only. **Do not inflate above 20psi.**

CLEANING

After each use thoroughly wash the spreader and clean material out of the hopper.

STORING

Never allow material to stay in the hopper for extended periods of time.

Before storing, ensure that the spreader is clean and dry.

Store indoors or in a protected area during severe weather and in the winter months.

CHECK ALL NUTS, BOLTS AND FASTENING

Periodically check all fastenings are tight & secure.

NEVER EXCEED LOAD CAPACITY

To avoid damaging the spreader, never exceed the rated load capacity of 57kg (125lb).

PARTS DIAGRAM – S P R 5 7 1

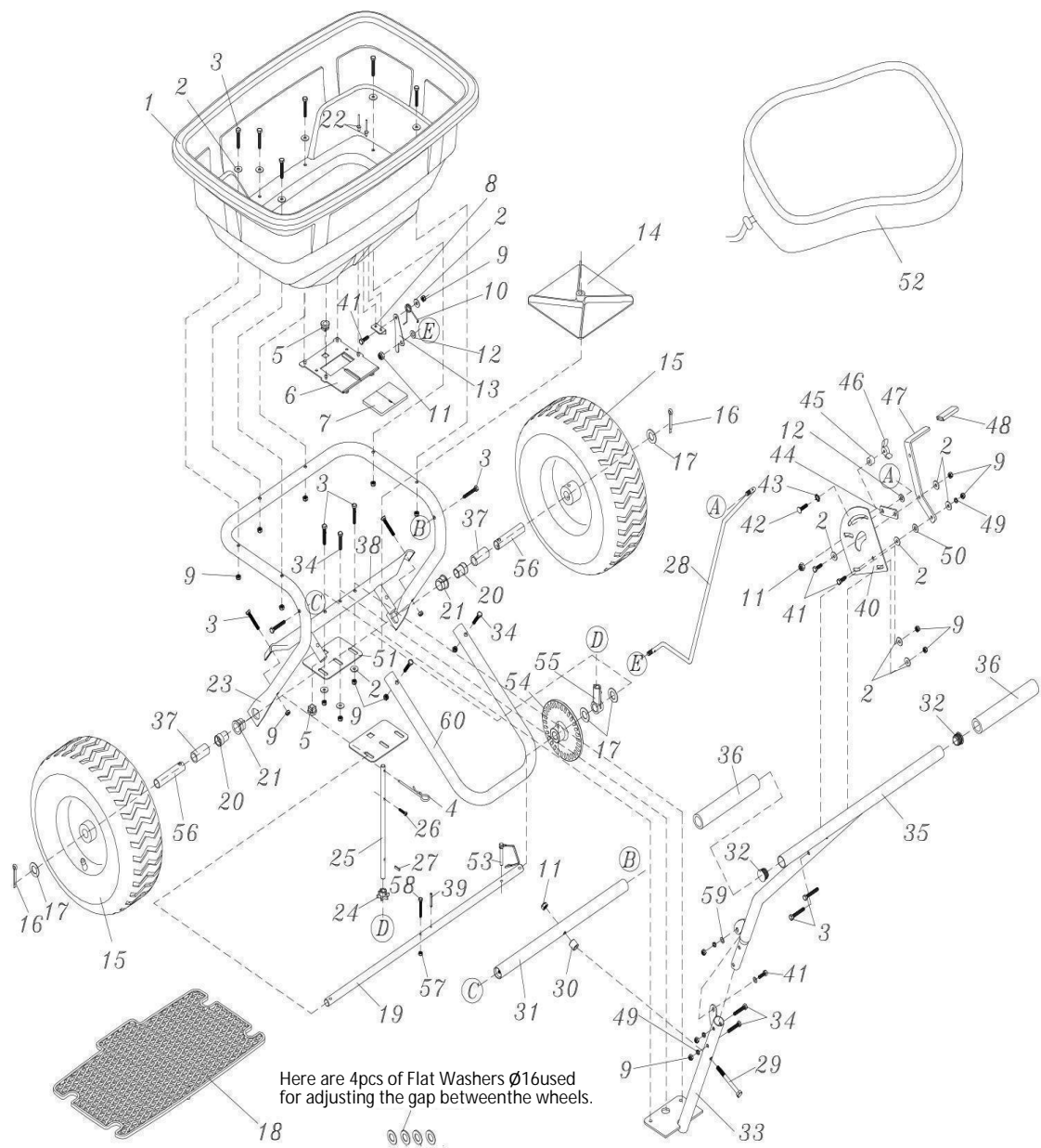

PARTS LIST – S P R 5 7 1

Item No.	Description	Qty
1	Hopper	1
2	Large Washer Ø6	16
3	Hex Bolt M6X40	14
4	R Pin Ø3	1
5	Bearing	2
6	Fixed Adjustable Plate	1
7	Active Adjustable Plate	1
8	Base for Spring	1
9	Lock Nut M6	21
10	Spring	1
11	Lock Nut M8	3
12	Flat Washer Ø8	2
13	Fixed Plate for Connecting Rod	1
14	Impeller	1
15	Wheel	2
16	Cotter Pin Ø5	2
17	Flat Washer Ø16	8
18	Screen	1
19	Axle	1
20	Inner Axle Bushing	2
21	Outer Axle Bushing	2
22	Rivet	2
23	Frame Tube Assembly	1
24	Pinion Gear	1
25	Swivel Axle	1
26	Screw M4X20	1
27	Spring Pin Ø3	1
28	Solid Linkage	1
29	Lock Nut M5	1
30	Hex Bolt M5X40	1

Item No.	Description	Qty
31	Hex Bolt M8X75	1
32	Spacer	1
33	Fixed Crossover Tube	1
34	Plastic Cap	2
35	Support Leg	1
36	Hex Bolt M6X35	5
37	Handle	1
38	Handle Cover	2
39	Axle Bushing	2
40	Crossover Tube	1
41	Spring Pin Ø4	1
42	Bracket	1
43	Hex Bolt M6X20	4
44	Bolt M6X25	1
45	Lock Washer	1
46	Connecting Plate	1
47	Spacer	1
48	Wing Nut	1
49	Adjusting Handle	1
50	Handle Cover	1
51	Spring Washer Ø6	4
52	Nylon Washer	1
53	Shaft Support Plate	1
54	Rain Cover	1
55	Drive Pin	1
56	Gear(Driver)	1
57	Shaft Support Cap	1
58	Wheel Bushing	2
59	Flat Washer Ø6	2
60	U-shaped support leg	1